

PRESSURE TRANSDUCER

CATALOG # 3669

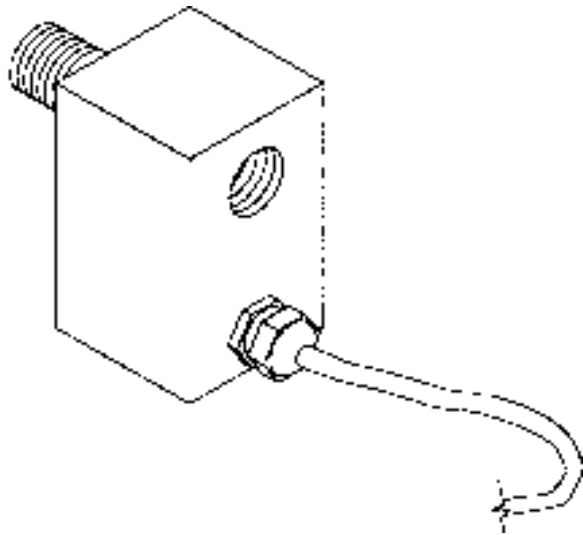

Spectrum
Technologies, Inc.

THANK YOU

Thank you for purchasing a Pressure Transducer to use with your WatchDog Data Logger in conjunction with an Irrrometer Tensiometer to log soil moisture. This manual will aid you in placing and mounting of the Pressure Transducer. Read it thoroughly to insure proper and effective use.

GENERAL OVERVIEW

The Pressure Transducer includes a 6 foot cable that is plugged into an available external port on a Model 200, 225, 425, or 450 WatchDog Data Logger. Once the Tensiometer (with the Pressure Transducer installed) has been positioned at the desired sensor depth, connect the cable to the WatchDog external channel to log soil moisture data.

Place the Irrrometer Tensiometer in an area which is appropriate for monitoring the conditions in which the plant is experiencing. Contact your cooperative extension agricultural agent for further suggestions. Refer to the **Irrrometer Tensiometer Instructions** for complete details.

Use **SpecWare** software to program the WatchDog to log soil moisture. Refer to the **SpecWare Instruction Manual** for detailed launch and/or readout instructions.

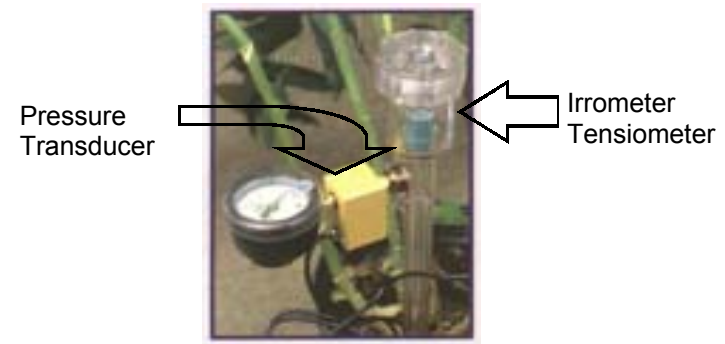

INSTALLATION

The Pressure Transducer includes a 6 foot cable that is plugged into an available external port on a Model 200, 225, 425, or 450 WatchDog Data Logger after installing the transducer. To install the transducer:

- 1) Remove vacuum gauge from Irrrometer Tensiometer with a 9/16" wrench.
- 2) Apply thread sealant and screw the transducer into the Irrrometer Tensiometer. Tighten with a wrench.
- 3) Use a thread sealant on fittings. Screw the vacuum gauge into the transducer. The gauge should be facing up.
- 4) Prepare the Tensiometer for field installation as per IRRROMETER'S instructions.

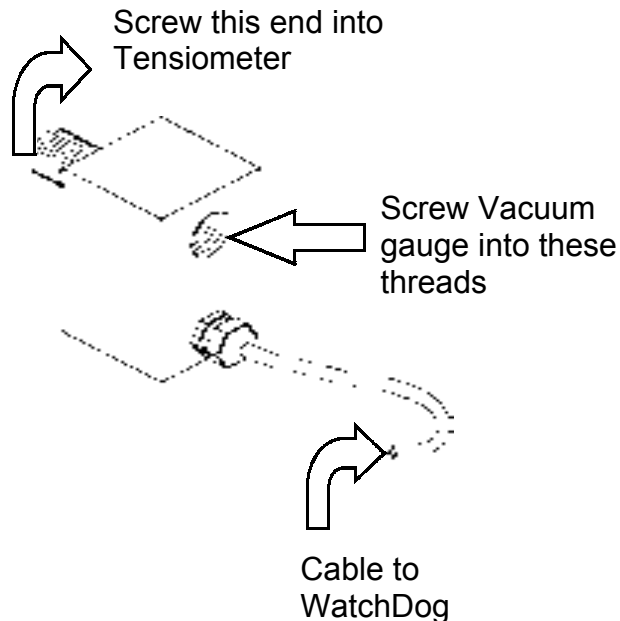

WARRANTY

This product is warranted to be free from defects in material or workmanship for 1 year from the date of purchase. During the warranty period Spectrum will, at its option, either repair or replace products that prove to be defective. This warranty is void if the Spectrum products have been damaged by customer error or negligence or if there has been an unauthorized modification.

Returning Products to Spectrum

Before returning a failed unit, you must obtain a Returned Goods Authorization (RGA) number from Spectrum. You must ship the product(s), properly packaged against further damage, back to Spectrum (at your expense) with the RGA number marked clearly on the outside of the package. Spectrum is not responsible for any package that is returned without a valid RGA number or for the loss of the package by any shipping company.

Spectrum Technologies, Inc
23839 W Andrew Rd
Plainfield IL 60544
(800) 248-8873 or (815) 436-4440
Fax (815) 436-4460
E-Mail: info@specmeters.com
www.specmeters.com